

永磁直流行星齿轮电机 PM DC Planetary Gear Motor

48JXT200K/45ZY68

Φ48超大力矩型减速器, 允许转矩范围: 20N.m
48mm OD Large Torque Gearbox, Permissible Load Range: 20N.m

48JXGT200K/45ZY68

Φ48长寿命、超大力矩型减速器, 允许转矩范围: 20N.m
48mm OD Long Life & Large Torque Gearbox, Permissible Load Range: 20N.m

● 外形和安装尺寸 Dimensions

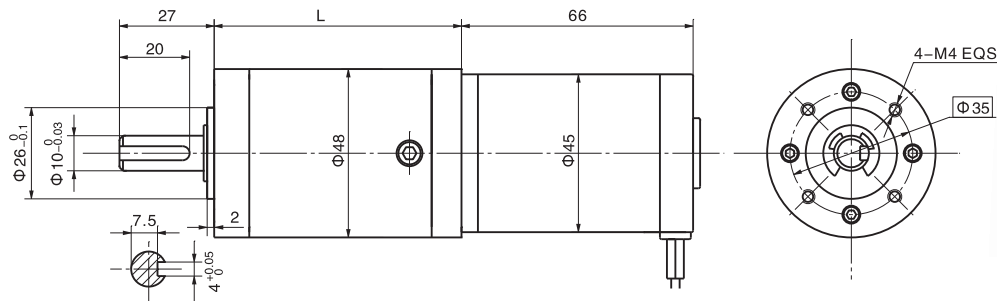

● 电动机主要技术参数 Motor Technical Data

电机型号 Type	额定电压 Rated voltage VDC	空载转速 No-load speed r/min	空载电流 No-load current A	额定转速 Rated speed r/min	额定转矩 Rated torque mN.m	输出功率 Output power W	额定电流 Rated current A	堵转转矩 Stall torque mN.m	堵转电流 Stall current A
45ZY68-2420	24	2000	0.13	1550	40	6.3	0.46	180	1.8
45ZY68-2430	24	3000	0.25	2500	43	11	0.80	176	2.7

● 齿轮减速电机主要技术参数 Gear Motor Technical Data

配置45ZY68-2420直流电机 (45ZY68-2420 DC Motor)

减速比 Reduction ratio	247	316	403	515	944	1206	1540	2510
减速级数 Number of gear trains	4	4	4	4	5	5	5	5
减速器长度(L) Length(L) mm	70.4	70.4	70.4	70.4	80.6	80.6	80.6	80.6
空载转速 No-load speed r/min	8.1	6.3	5.0	3.9	2.1	1.7	1.3	0.8
额定转速 Rated speed r/min	6.3	4.9	3.8	3.0	1.6	1.3	1.0	0.6
额定转矩 Rated torque N.m	6.5	8.3	11	14	20	20	20	20
最大瞬间允许负载 Max. permissible load in a short time N.m	60	60	60	60	60	60	60	60

配置45ZY68-2430直流电机 (45ZY68-2430 DC Motor)

减速比 Reduction ratio	247	316	403	515	944	1206
减速级数 Number of gear trains	4	4	4	4	5	5
减速器长度(L) Length(L) mm	70.4	70.4	70.4	70.4	80.6	80.6
空载转速 No-load speed r/min	12	9.5	7.4	5.8	3.2	2.5
额定转速 Rated speed r/min	10	7.9	6.2	4.9	2.6	2.1
额定转矩 Rated torque N.m	7.0	9.0	11	15	20	20
最大瞬间允许负载 Max. permissible load in a short time N.m	60	60	60	60	60	60