

永磁直行星齿轮电机 PM DC PLANETARY GEAR MOTOR

42JXD100K/42ZY75

Φ42 加强型减速器 (短型), 允许转矩范围: 1N.m~10N.m
42mm OD Reinforced Gearbox(Shorter),
Permissible Load Range: 1N.m~10N.m

● 外形和安装尺寸 Dimensions

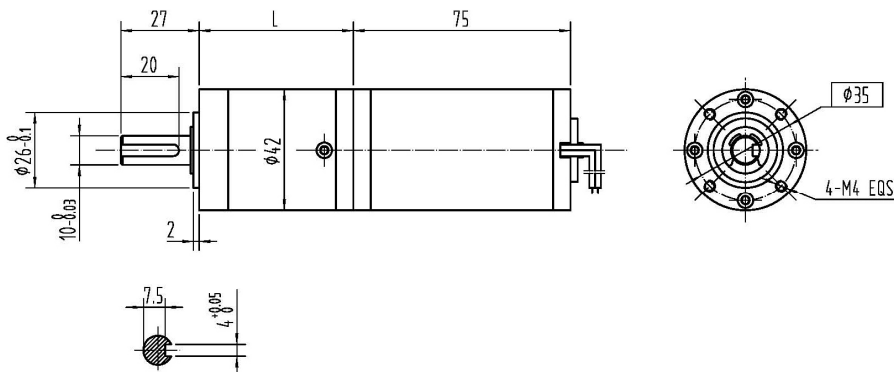

● 电动机主要技术参数 Motor Technical Data

电机型号 TYPE	额定电压 Rated voltage VDC	空载转速 No-load speed r/min	空载电流 No-load current A	额定转速 Rated speed r/min	额定转矩 Rated torque m.Nm	输出功率 Output power W	额定电流 Rated current A	堵转力矩 Stall torque m.Nm	堵转电流 Stall current A
42ZY75-2420	24	2000	0.10	1600	35	5.9	0.42	183	1.73
42ZY75-2430	24	3000	0.15	2500	44	11.5	0.75	259	3.55
42ZY75-2440	24	4000	0.20	3400	50	17.8	1.10	336	6.09

● 齿轮减速电机主要技术参数 Gearmotor Technical Data

配置 42ZY75-2420 直流电机 (42ZY75-2420DC Motor)

减速比 Reduction ratio	13	22	49	59	68	82	95	115	181	218	253	305	354	426	495
减速级数 Number of gear trains	2	2	3	3	3	3	3	3	4	4	4	4	4	4	4
减速器长度(L) Length(L) mm	45.4	45.4	53.3	53.3	53.3	53.3	53.3	53.3	61.2	61.2	61.2	61.2	61.2	61.2	61.2
空载转速 No-load speed /min	154	91	41	34	29	24	21	17	11	9.2	7.9	6.6	5.6	4.7	4.0
额定转速 Rated speed r/min	123	73	33	27	24	20	17	14	8.8	7.3	6.3	5.2	4.5	3.8	3.2
额定转矩 Rated torque N.m	0.37	0.62	1.3	1.5	1.7	2.1	2.4	2.9	4.1	5.0	5.8	6.9	8.1	9.7	10
最大瞬间允许负载 Max. permissible load in a short time N.m	12	12	25	25	25	25	25	25	30	30	30	30	30	30	30

配置 42ZY75-2430 直流电机 (42ZY75-2430DC Motor)

减速比 Reduction ratio	13	22	49	59	68	82	95	115	181	218	253	305	354	426
减速级数 Number of gear trains	2	2	3	3	3	3	3	3	4	4	4	4	4	4
减速器长度(L) Length(L) mm	45.4	45.4	53.3	53.3	53.3	53.3	53.3	53.3	61.2	61.2	61.2	61.2	61.2	61.2
空载转速 No-load speed /min	231	136	61	51	44	37	32	26	17	14	12	10	8.5	7.0
额定转速 Rated speed r/min	192	114	51	42	37	30	26	22	14	11	10	8.2	7.1	5.9
额定转矩 Rated torque N.m	0.46	0.78	1.6	1.9	2.2	2.6	3.1	3.7	5.2	6.2	7.2	8.7	10	10
最大瞬间允许负载 Max. permissible load in a short time N.m	12	12	25	25	25	25	25	25	30	30	30	30	30	30

配置 42ZY75-2440 直流电机 (42ZY75-2440DC Motor)

减速比 Reduction ratio	13	22	49	59	68	82	95	115	181	218	253	305	354
减速级数 Number of gear trains	2	2	3	3	3	3	3	3	4	4	4	4	4
减速器长度(L) Length(L) mm	45.4	45.4	53.3	53.3	53.3	53.3	53.3	53.3	61.2	61.2	61.2	61.2	61.2
空载转速 No-load speed /min	308	182	82	68	59	49	42	35	22	18	16	13	11
额定转速 Rated speed r/min	262	155	69	58	50	41	36	30	19	16	13	11	10
额定转矩 Rated torque N.m	0.53	0.89	1.8	2.2	2.5	3.0	3.5	4.2	5.9	7.1	8.2	9.9	10
最大瞬间允许负载 Max. permissible load in a short time N.m	12	12	25	25	25	25	25	25	30	30	30	30	30