

永磁直流行星齿轮电机 PM DC Planetary Gear Motor

24JX5K/24ZY30

Φ24标准型减速器, 允许转矩范围: 0.05N.m~0.5N.m
 24mm OD Standard Gearbox,
 Permissible Load Range: 0.05N.m~0.5N.m

● 外形和安装尺寸 Dimensions

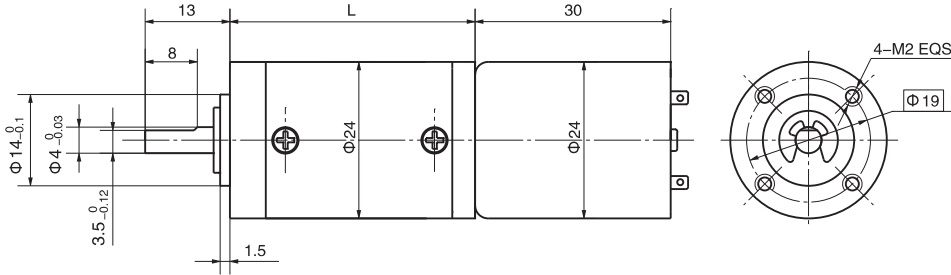

● 电动机主要技术参数 Motor Technical Data

| 电机型号 Type | 额定电压 Rated voltage VDC | 空载转速 No-load speed r/min | 空载电流 No-load current mA | 额定转速 Rated speed r/min | 额定转矩 Rated torque mN.m | 输出功率 Output power W | 额定电流 Rated current mA | 堵转力矩 Stall torque mN.m | 堵转电流 Stall current A |
|--------------|------------------------------|--------------------------------|-------------------------------|------------------------------|------------------------------|---------------------------|-----------------------------|------------------------------|----------------------------|
| 24ZY30-1230 | 12 | 3000 | 40 | 2400 | 2 | 0.5 | 90 | 10 | 0.3 |
| 24ZY30-1245 | 12 | 4500 | 60 | 3600 | 2.5 | 0.9 | 170 | 12.5 | 0.5 |
| 24ZY30-1260 | 12 | 6000 | 70 | 4800 | 3 | 1.5 | 240 | 15 | 1.0 |

● 齿轮减速电机主要技术参数 Gear Motor Technical Data

配置24ZY30-1230直流电机 (24ZY30-1230 DC Motor)

| 减速比 Reduction ratio | 51 | 71 | 100 | 139 | 189 | 264 | 369 | 516 | 720 | 981 | 1370 | 1913 | 2671 | 3730 |
|---|-------|------|------|------|------|------|------|------|------|------|------|------|------|------|
| 减速级数 Number of gear trains | 3 | 3 | 3 | 3 | 4 | 4 | 4 | 4 | 4 | 5 | 5 | 5 | 5 | 5 |
| 减速器长度(L) Length(L) mm | 32.7 | 32.7 | 32.7 | 32.7 | 37.6 | 37.6 | 37.6 | 37.6 | 37.6 | 42.5 | 42.5 | 42.5 | 42.5 | 42.5 |
| 空载转速 No-load speed r/min | 59 | 42 | 30 | 22 | 16 | 11 | 8.1 | 5.8 | 4.2 | 3.1 | 2.2 | 1.6 | 1.1 | 0.80 |
| 额定转速 Rated speed r/min | 47 | 34 | 24 | 17 | 13 | 9.1 | 6.5 | 4.7 | 3.3 | 2.4 | 1.8 | 1.3 | 0.90 | 0.64 |
| 额定转矩 Rated torque N.m | 0.074 | 0.10 | 0.15 | 0.20 | 0.25 | 0.34 | 0.48 | 0.5 | 0.5 | 0.5 | 0.5 | 0.5 | 0.5 | 0.5 |
| 最大瞬间允许负载 Max. permissible load in a short time N.m | 1.2 | 1.2 | 1.2 | 1.2 | 1.5 | 1.5 | 1.5 | 1.5 | 1.5 | 1.5 | 1.5 | 1.5 | 1.5 | 1.5 |

配置24ZY30-1245直流电机 (24ZY30-1245 DC Motor)

| 减速比 Reduction ratio | 3.7 | 5.2 | 14 | 19 | 27 | 51 | 71 | 100 | 139 | 189 | 264 | 369 | 516 | 720 |
|---|-------|-------|-------|-------|-------|------|------|------|------|------|------|------|------|------|
| 减速级数 Number of gear trains | 1 | 1 | 2 | 2 | 2 | 3 | 3 | 3 | 3 | 4 | 4 | 4 | 4 | 4 |
| 减速器长度(L) Length(L) mm | 25.4 | 25.4 | 27.8 | 27.8 | 27.8 | 32.7 | 32.7 | 32.7 | 32.7 | 37.6 | 37.6 | 37.6 | 37.6 | 37.6 |
| 空载转速 No-load speed r/min | 1213 | 869 | 321 | 237 | 167 | 88 | 63 | 45 | 32 | 24 | 17 | 12 | 8.7 | 6.3 |
| 额定转速 Rated speed r/min | 970 | 695 | 257 | 189 | 133 | 71 | 51 | 36 | 26 | 19 | 14 | 10 | 7.0 | 5.0 |
| 额定转矩 Rated torque N.m | 0.008 | 0.012 | 0.028 | 0.038 | 0.055 | 0.09 | 0.13 | 0.18 | 0.25 | 0.31 | 0.43 | 0.5 | 0.5 | 0.5 |
| 最大瞬间允许负载 Max. permissible load in a short time N.m | 0.15 | 0.15 | 0.6 | 0.6 | 0.6 | 1.2 | 1.2 | 1.2 | 1.2 | 1.5 | 1.5 | 1.5 | 1.5 | 1.5 |

配置24ZY30-1260直流电机 (24ZY30-1260 DC Motor)

| 减速比 Reduction ratio | 3.7 | 5.2 | 14 | 19 | 27 | 51 | 71 | 100 | 139 | 189 | 264 | 369 | 516 | 720 |
|---|-------|-------|-------|-------|-------|------|------|------|------|------|------|------|------|------|
| 减速级数 Number of gear trains | 1 | 1 | 2 | 2 | 2 | 3 | 3 | 3 | 3 | 4 | 4 | 4 | 4 | 4 |
| 减速器长度(L) Length(L) mm | 25.4 | 25.4 | 27.8 | 27.8 | 27.8 | 32.7 | 32.7 | 32.7 | 32.7 | 37.6 | 37.6 | 37.6 | 37.6 | 37.6 |
| 空载转速 No-load speed r/min | 1617 | 1158 | 429 | 316 | 222 | 118 | 85 | 60 | 43 | 32 | 23 | 16 | 12 | 8.3 |
| 额定转速 Rated speed r/min | 1294 | 927 | 343 | 253 | 178 | 94 | 68 | 48 | 35 | 25 | 18 | 13 | 9.3 | 6.7 |
| 额定转矩 Rated torque N.m | 0.010 | 0.014 | 0.034 | 0.046 | 0.066 | 0.11 | 0.16 | 0.22 | 0.30 | 0.37 | 0.5 | 0.5 | 0.5 | 0.5 |
| 最大瞬间允许负载 Max. permissible load in a short time N.m | 0.15 | 0.15 | 0.6 | 0.6 | 0.6 | 1.2 | 1.2 | 1.2 | 1.2 | 1.5 | 1.5 | 1.5 | 1.5 | 1.5 |